



[tool-traders-partner.com](http://tool-traders-partner.com)

The tool specialists for trade.



## HPH chucks

 **WTE**  
PRÄZISIONSTECHNIK



## High precision from the Erzgebirge with the courage to innovate

As an international active company, WTE Präzisionstechnik GmbH is a technologically orientated production plant which develops and produces with its own engineering and development department innovations for the clamping technology sector. Core competencies are in precision drill chuck systems, in hydraulic chucks and in shrinking technology. With the precision drill chuck product range WTE has achieved market leadership in Europe. Further products in high-precision clamping technology will follow. Currently WTE can rely on almost 100 highly-qualified and dedicated

employees who enjoy continuous ongoing internal trainings in order to meet the high quality standards.

Not only the ongoing development and innovations for solving production-specific problems, but also the steady strengthening of the German facilities are at the core of the WTE philosophy. With the installation of an air conditioned grinding shop, WTE has laid the foundation stone for strengthening the production site in Germany and for creating a new chance in the region for allowing further jobs to develop over the course of the years.

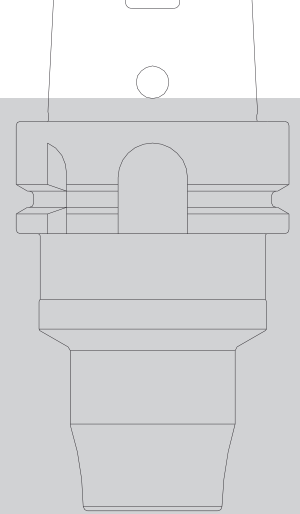

WTE Präzisionstechnik GmbH with its production facility in Ehrenfriedersdorf.



**Strategically planned  
and precisely imple-  
mented in the tool.**



The philosophy of WTE Präzisionstechnik GmbH is lived in its daily work. We stand for innovation - precision - competence - service and are your partners for the future. That means in detail that only products of the highest quality in the  $\mu$  range leave the production, that technical competence, training and on-site support are available to the customer. WTE has been certified to the ISO 9001:2008 quality management standard since 2001.

Customers of WTE Präzisionstechnik GmbH can rely on flexible and fast service potential. High flexibility and fast reactions to customers' wishes is the credo at WTE. The high process stability, the production site in Germany and 100% dependable employees form the basis for the corporate philosophy.



Grinding is one of the largest field of know-how at WTE.



High-quality machining centres in operation.



Shrink fit chucks

HPH chucks

Hydraulic chucks

Special tools

Standard drill chucks

Precision drill chucks



Quality control is one of the most important production principles at WTE for generating long-term customer satisfaction on the market.

#### Our product portfolio:

We offer high-precision solutions for machining centres and CNC lathes, HSC machining up to 35,000 rpm, for drilling, countersinking, reaming, thread cutting/drilling/milling, roughing, for heavy machining, HPC and hard machining as well as wood machining.

**WTE**  
PRÄZISIONSTECHNIK



## DIN 69893

balanced G 2.5 at 25,000 min<sup>-1</sup>

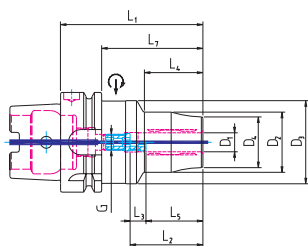

Ref.N°	HSK-A	d <sub>1</sub>	d <sub>2</sub>	d <sub>3</sub>	d <sub>4</sub>	l <sub>1</sub>	l <sub>2</sub>	l <sub>3</sub>	l <sub>4</sub>	l <sub>5</sub>	l <sub>7</sub>	g	kg	€
PG 645														
16.407.63.06.Z	63	6	32	50	26	80	37	10	26	27	54	M5	1,1	413,00
16.407.63.08.Z	63	8	34	50	8	80	37	10	27	27	54	M6	1,1	413,00
16.407.63.10.Z	63	10	36	50	30	85	41	10	32	31	59	M8x1	1,2	413,00
16.407.63.12.Z	63	12	38	52.5	32	90	46	10	37	36	64	M10x1	1,3	383,00
16.407.63.14.Z	63	14	40	52.5	34	90	46	10	37	36	64	M10x1	1,3	413,00
16.407.63.16.Z	63	16	42	52.5	36	95	49	10	42	39	69	M12x1	1,5	413,00
16.407.63.18.Z	63	18	44	52.5	38	95	49	10	42	39	69	M12x1	1,5	397,00
16.407.63.20.Z	63	20	48	52.5	42	100	51	10	45	41	74	M16x1	1,5	383,00
16.407.63.25.Z	63	25	57	53	51	120	57	10	62	47	94	M16x1	2,1	413,00
16.407.63.32.Z	63	32	63	53	57	125	61	10	62	51	99	M16x1	2,3	413,00

PG 645

Scope of supply: includes Allen-“T“-Wrench.



## DIN 69871-AD/B

balanced G 2.5 at 25,000 min<sup>-1</sup>

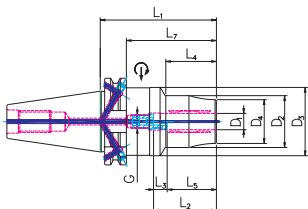

Ref.N°	SK	d <sub>1</sub>	d <sub>2</sub>	d <sub>3</sub>	d <sub>4</sub>	l <sub>1</sub>	l <sub>2</sub>	l <sub>3</sub>	l <sub>4</sub>	l <sub>5</sub>	l <sub>7</sub>	g	kg	€
PG 645														
15.407.40.06.Z	40	6	32	50	26	75	37	10	26	27	56	M5	1	383,00
15.407.40.08.Z	40	8	34	50	28	75	37	10	27	27	56	M6	1	383,00
15.407.40.10.Z	40	10	36	50	30	80	41	10	32	31	61	M8x1	1	383,00
15.407.40.12.Z	40	12	38	50	32	85	46	10	37	36	66	M10x1	1	340,00
15.407.40.14.Z	40	14	40	50	34	85	46	10	37	36	66	M10x1	1	383,00
15.407.40.16.Z	40	16	42	50	36	90	49	10	42	39	71	M12x1	1	383,00
15.407.40.18.Z	40	18	44	50	38	90	49	10	42	39	71	M12x1	1	383,00
15.407.40.20.Z	40	20	48	50	42	95	51	10	45	41	76	M16x1	1	340,00
15.407.40.25.Z	40	25	57	50	51	110	57	10	60	47	91	M16x1	2	383,00
15.407.40.32.Z	40	32	63	50	57	120	61	10	65	51	101	M16x1	2	383,00

PG 645

Scope of supply: includes Allen-“T“-Wrench

**Direct clamping - clamping diameter in mm - torque in Nm**

Clamping diameter in mm	6	8	10	12	14	16	20
Torque for shank minimum size h6 in Nm	50	90	130	200	250	310	550

! Additional cost for balancing G 6.3: € 14.-- | G 2.5: € 20,-- !



**3 good reasons for more success.**

## ► 1. Quality and precision “Made in Germany”

We are convinced that quality and precision requirements at the level demanded by the automotive and aerospace industry can only be achieved at an economical price-performance ratio by products and services that are developed, planned, designed and manufactured in Germany. Highly developed production methods, the latest production

plants and infrastructure as well as the best working conditions for qualified, committed employees make possible a very high quality standard and unlock precision in the  $\mu$  range. Our partner businesses all have active quality management systems and are certified in accordance with ISO 9001.

## ► 2. Worldwide leading competence

The partners in “tool-traders-partner.com” are technology leaders and as brands enjoy a high level of international recognition and an excellent image. They have excellent specialists with decades of experience and

collective specialist knowledge. They stand for continuity and innovation. For the user this means always being one step ahead with the latest tool technology.

## ► 3. Optimal advice and assistance

A comprehensive range of stock products, efficient logistics, and the high flexibility of the partners ensure that the products are available quickly to suit the needs of the trade. The training of the sales staff orientated on the trade, the competent support provided by application engineers, specific

training courses as well as a comprehensive information system combine to provide a level of support that ensures our trade partners have a lead due to more competence and better service.

The partners in  
tool-traders-partner.com

**BECK**   
Präzisionswerkzeuge



August Beck GmbH  
& Co. KG in Winterlingen

**MILLER**  
PRÄZISIONSWERKZEUGE



MILLER GmbH Präzisions-  
werkzeuge in Albstadt

 **WTE**  
PRÄZISIONSTECHNIK



WTE Präzisionstechnik  
GmbH in Kempten

### ► 100 years of experience

The competence and experience from more than 100 years make BECK a dependable partner in demand for bore machining. The comprehensive standard programme includes reaming and countersinking tools and covers the complete cutting material spectrum from HSS to PCD and PCBN. This programme is supplemented by high performance reamers and custom tools that offer users that crucial performance plus.

### ► Standard re-defined

The product range from MILLER includes a comprehensive standard programme of stock precision tools for drilling, milling and countersinking made of solid carbide. In 2008 a considerable investment made it possible to set-up one of the largest and most modern solid carbide tool factories in Europe. The production area was more than doubled, in addition a highly modern logistics centre was established. This expansion is safeguarding the high quality standard of MILLER products and increasing availability.

### ► The innovation leader

As a technology-orientated, international business, WTE develops and produces innovative machining technology. Its core competences are in precision drill chuck systems, in the hydraulic chucking sector and in shrinking technology. In the area of precision drill chucks WTE has achieved market leadership in Europe. Precision and quality paired with a high level of competence in service make WTE a dependable partner.



- ▶ Precision drill chucks
- ▶ Hydraulic chucks
- ▶ HPH chucks
- ▶ Shrink fit chucks
- ▶ Standard drill chucks
- ▶ Shrink units/cooling units

All prices quoted in the catalogue are unit prices exclusive of the statutory value-added tax. Technical modifications reserved



V<sub>5</sub> 5bA<sup>°</sup> • d<sup>^</sup> à<sup>v</sup> q<sup>!</sup> K

**CENTRALA TECHNICZNA**  
**ELTECH** 

Ô\} dæÁ^&@ æ } æ ÖŠVÒÔPÂŮ] Ě Á È È  
~|Æòà!^ & } æ FĤH  
í | Ē € Ą , ä } æ  
  
ç | Ě Ĭ Ĩ Ī Ĵ Ķ Ĳ  
-æ Ę Ĭ Ĩ Ī Ĵ Ķ Ĳ  
  
^ | ç & @ ^ | ç & @ { Ħ |  
. . . Ę ç & @ { Ħ |



Tel.: 00 49 (0) 8 31-5 70 12-0  
Fax: 00 49 (0) 8 31-5 70 12-30  
info@wte-tools.de  
www.wte-tools.de